



博志达机械
BOZHIDA MACHINERY



博志达机械
BOZHIDA MACHINERY

东莞市博志达工程机械制造有限公司
DONGGUAN BOZHIDA ENGINEERING MACHINERY MANUFACTURE CO.,LTD.

地址：广东省东莞市大岭山镇杨屋社区杨朗路

东莞市博志达工程机械制造有限公司

DONGGUAN BOZHIDA ENGINEERING MACHINERY MANUFACTURE CO.,LTD.

专业致力于挖掘机前端工作装置的研发、制造和销售

We are dedicated to the research, development, manufacture and sales of excavator front-end working equipment.

公司简介

Company Profile



火焰切割机器人



加长臂推土机



双履带球



机加工车间

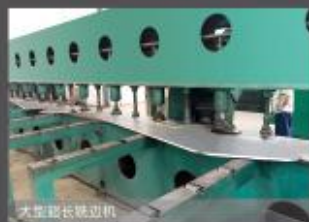

大型超长铣边机



喷漆与烘干设备



喷砂设备



超声波探伤仪



东莞市博志达工程机械制造有限公司位于珠三角制造业名城东莞市大岭山镇，毗邻深圳和广州，紧临107国道，厂深、莞深常虎高速公路，交通便利，环境优越。

公司致力于自主研发，生产各品牌挖掘机加长臂、打桩臂、拆楼臂、岩石臂、标准臂以及松土器、挖斗、清渣斗、装载机、压实轮、抓木器、抓钢机等挖掘机前端工作装置，是一家面向海内外市场、具有良好的发展前景和较强综合实力的企业。

“工欲善其事，必先利其器”从设计、制作到检测，公司导入了先进的计算机辅助设计系统，配备了数控等离子切割机、火焰切割机器人、自动焊接专机、变位机、折弯机、卷板机、铁边机、双面落地镗床、数控车床、喷砂与喷涂设备以及高压模拟试验台、液压试验台、超声波探伤仪等加工、检测设备，为确保生产能力和制作质量的不断提升奠定了坚实基础。

公司通过了ISO9001质量管理体系认证，我们始终坚持以“促进挖掘机多功能化，提升客户使用价值”的企业宗旨，遵循“超越不止，追求无限，服务大众，回报社会”的经营理念，以诚信为基，以品质为准，坚持开拓创新、精益求精的发展方向，推行精品战略，打造特色品牌，重视个性化产品设计，不断进行技术创新，以求最大化地满足客户价值提升的需求，继续为客户提供优质的产品与服务，打造博志达挖掘机前端工作装置的专业制造品牌。

Dongguan BOZHIDA Engineering Machinery Manufacture Co., Ltd. is located at the Dalingshen Town, Dongguan City, which is the famous city of manufacturing in Pearl River Delta. It is adjacent to Shenzhen and Guangzhou, next to the 107 national road, Guangdong-shenzhen highway, Dongguan-Shenzhen highway and Changpin-Humen highway, with convenient transportation and elegant environment.

The company is specializing in the self research and development, producing excavator and loader attachments such as long reach arm and boom, sheet piling arm and boom, high reach demolition, rock arm and boom, standard arm and boom, ripper, bucket, loader bucket, compaction wheel, grapple and hydraulic orange peel grab, which is an enterprise to face the market at home and abroad, possessing the bright prospect and strong comprehensive strength.

"A workman must first sharpen his tools if he is to do his work well." From design, production to inspection, the company duly imports advanced Computer Aided Design (CAD) System, equipped with CNC plasma cutting machine, flame cutting robot, automatic welding Machine, welding positioner, bending machine, rolling machine, edge milling machine, large honing machine, digital control lathe, large floor type boring machine, pickling phosphating pool, sand-blast and spray equipment, high pressure simulation test platform, hydraulic test platform, ultrasonic fault detector to ensure the production capacity and quality.

The company has passed ISO9001 quality management system certification. Over the years, BOZHIDA company consistently adheres to business concept "Beyond more than the pursuit of unlimited, public services, social returns", good faith-based, quality-oriented. It sticks to the innovation and excellence to promote the exquisite article strategy, build characteristic brand, pay more attention to the design of individual products, and continuously innovate the technology, thus to greatly satisfy the demand for improving the customer value. Build BOZHIDA excavator attachments professional manufacturing brand.



Corporate Culture

企业文化

Enterprise Tenet

Promote excavator Multi-function change,
Enhance customer use value

Managerial Philosophy

Beyond more than the pursuit of unlimited,
public services, social returns

Enterprise Spirit

Development innovation, Keep improving

Enterprise Style

Honesty pragmatic and efficient

企业宗旨：促进挖机多功能化，提升客户使用价值

经营理念：超越不止，追求无限，服务大众，回报社会

企业精神：开拓创新，精益求精

企业作风：诚信务实，快捷高效



组织架构

Company Structure



三段式加长臂 High Reach Demolition



性能特征 Characteristics

公司可根据客户具体需求，为各种品牌挖掘机设计、生产各种规格三段式加长臂。通过先进的电脑辅助设计系统，结合博志达机械十余年加长臂设计制造经验和成熟的生产加工工艺，应用有限元方法分析加长臂应力分布，对三段臂结构进行优化设计，确保三段臂质量稳定可靠。

三段式加长臂材料选用Q345B或Q550D，主要适用于高层建筑的拆解等工程。

The company can design and produce high reach demolition for excavators of various brands according to customers' requirement. With advanced computer-assisted design system, more than ten years' design and manufacturing experience of long reaches. The application of finite element method to analysis long reaches stress distribution. We make better design to high reach demolition's structure. Our high reach demolition is stable and reliable.

The material of high reach demolition is Q345B, high reach demolition is applied to demolish high-rise buildings.



技术参数 Parameter

机重 Models	22T	30T	35T	40T	45T
三段臂总长 (mm) Total length	16000	18000	20000	22000	24000
工作重量 (Kg, 参考) Weight	5000	6000	7000	8000	9000
液压剪限制重量 (Kg) Limitation for weight of shear	under 2000	under 2000	under 2000	under 2000	under 2000
运输高度 (mm, 参考) Transport height	3200	3300	3350	3400	3450



两段式加长臂 Long Reach Arm And Boom



CAT6020加长臂在新加坡施工现场



CAT6020加长臂在17吨田王石



EX1200加长臂在吊袋田王石

性能特征 Characteristics

公司可根据客户具体需求，为各种品牌挖掘机设计、生产各种标准和非标的两段式加长臂。通过先进的电脑辅助设计系统，结合博志达机械十余年加长臂设计制造经验和成熟的生产加工工艺，应用有限元方法分析加长臂应力分布，对加长臂结构进行优化设计，确保加长臂质量稳定可靠。

二段式加长臂材料选用Q345B或Q550D，分为标准型和加强型。标准型适用于河道清淤、斜坡修整、深壁挖掘等轻载作业环境；加强型适用于硬土挖掘及碎石装载等作业环境。

The material of long reach is Q345B, two type of long reach is standard and enhanced. Standard long reach are applied to light load working as environment channel dredging, slope finishing, deep cut mining, etc. Enhanced long reaches are applied to hard soil mining and gravel loading working environment.

The company can design and produce standard booms and two-section long-reach booms for excavators of various brands according to customers' requirement. With advanced computer-assisted design system, more than ten years' design and manufacturing experience of long reaches, the application of finite element method to analysis long reach stress distribution, We make better design to long reach's structure. Our long reach is stable and reliable.

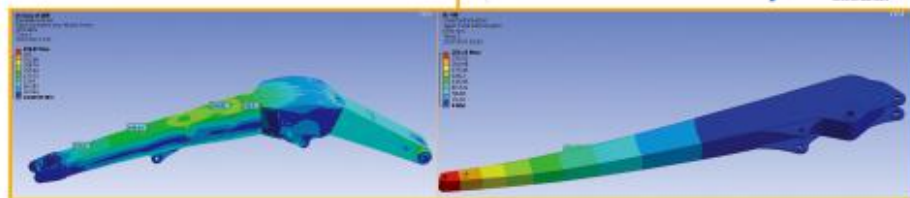

有限元分析 Finite element analysis



CAT6020B-7.5米加长臂常装17吨田王石



两段式加长臂 Long Reach Arm And Boom

适用范围 Application

二段式加长臂材料选用Q345B或Q550D, 分为标准型和加强型。标准型适用于河道清淤、斜坡修整、深桩挖掘等轻载作业环境; 加强型适用于硬土挖掘及卵石装载等作业环境。

The material of long reach is Q345B, two type of long reach is standard and enhanced. Standard long reach are applied to light load working as environment channel dredging, slope finishing, deep cut mining, etc; Enhanced long reaches are applied to hard soil mining and gravel loading working environment.



技术参数 Parameter

机重 Models	12T	20T	22T	30T	35T	40T	45T
动臂和斗杆总长 (mm) Total length	13000	15380	15380	18000	20000	22000	24000
工作重量 (Kg, 参考) Weight	3000	4000	4200	5200	6000	6500	7000
斗容量 (m ³) Bucket capacity	0.3	0.4	0.4	0.4	0.5	0.6	0.6
最大挖掘高度 (mm, 参考) Max.digging height	11300	12500	12600	13700	15000	16000	17200
最大外伸挖掘范围 (mm, 参考) Max.digging reach	12500	15000	15000	17500	19500	21500	23500
最大挖掘深度 (mm, 参考) Max.digging depth	9000	11300	11300	13000	15000	16500	18000
运输高度 (mm, 参考) Transport height	2900	3000	3050	3200	3250	3350	3400
附加配重 (Kg) Additional counterweight	根据各厂家机型和工况商定 Agreed according to the model and working condition of each manufacturer						



岩石臂 Rock Arm And Boom

适用范围 Application

岩石臂主要适用于中风化石和强风化岩石层的破碎解体。

Rock arm is mainly used to stroke the fossils and strong weathering rock crushing collapse.



性能特征 Characteristics

公司可根据客户要求，为各种品牌35吨位以上挖掘机设计、生产岩石臂。岩石臂的设计原理是：以动臂和斗杆连接点为支点，加长支点到斗杆油缸耳座孔中心距离的力臂，缩短支点到斗杆前套中心距离的力臂，增大斗杆油缸缸径获取足够大的作用力，通过杠杆原理，达到强力破坏。为确保岩石臂的顺利安装和使用，我们采取焊接后全镦孔加工工艺，延长了挖掘机的使用寿命。

The company can according to customer's requirements to design and manufacture rock arm for various brands more than 35 tonnage. Rock arm design principle is: With movable arm and bucket rod connection point for the fulcrum, Extended protection to the bucket rod oil cylinder lever of ear hole center distance, shorten the fulcrum to the front of the bucket rod set of lever of center distance, increasing the bucket rod oil cylinder bore to obtain large enough force, through the leverage theory to achieve strong damage. In order to ensure the smooth installation and use of rock arm, we take full bore processing technology after welding process, extend the service life of the excavator.



技术参数 Parameter

序号 Serial	名称 Item	配套机重(吨) Machine Tonnage (T)	长度(mm) Length	产品重量(Kg) Weight	适用机型 Applicable Models
1	动臂 Swing arm	35-40	5000	6800	CAT336, CAT340, PC400, SY365, ZX360, EC380
	斗杆 Bucket boom		3500	7200	
2	动臂 Swing arm	41-50	5100	8000	CAT345, CAT349, PC450, SY465, ZX450, EC480
	斗杆 Bucket boom		3700	9000	
3	动臂 Swing arm	51-65	5300	12000	CAT365, PC600, PC650, EX600
	斗杆 Bucket boom		4000	11500	
4	动臂 Swing arm	66-90	5700	13600	CAT374, CAT385, PC700, PC800, EX800, EX850, EC700, XE900
	斗杆 Bucket boom		4500	13000	



隧道臂 Tunnel Arm And Boom

性能特征 Characteristics

将动臂和斗杆前端工作装置缩短，以适应受高度和宽度限制的作业空间。可安装破碎锤和超大容量铲斗等附件，轻松完成在狭窄空间内的作业。

Shortened the arm and boom for adapting the working condition in certain environment with limited height and width. Installed with hydraulic breaker/hammer and oversized buckets for working efficiently in narrow working environment.

适用范围 Application

适用于山岳隧道工程、隧道建设工程的工作环境。

Apply to mountain tunnel construction projects or civil tunnel construction projects.



打桩臂 Sheet Piling Arm And Boom

性能特征 Characteristics

配套不同长度的打桩臂，可轻松实现打拔9米、12米、15米、18米、21米等长度的钢板桩，使沉桩或拔桩更加方便灵活。

Designed for piling different length of steel sheets, such as 9 meters, 12 meters, 15 meters, 18 meters, 21 meters...etc. To increase the working efficiency of pile-sinking and pile-pulling.

适用范围 Application

适用于围堰、堤坝、防土壤、斜坡面等基础工程施工。

Apply to the foundation construction, such as, cofferdam, dyke and slope...etc.



抓料臂 Material Handling Arm And Boom



性能特征 Characteristics

将动臂设计为长直臂，斗杆设计为长弯臂，斗杆油缸设计为双油缸，超大的作业范围极大提高了作业效率。

Designed the boom longer than standard boom, and the arm will be curved and longer type. Using double arm cylinders design for adapting wide working range and working efficiency. Offering enough working power.

适用范围 Application

适用于各种物料装卸的工作环境。根据装卸物料的种类，可选择橙皮状抓斗，铰壳式贝型抓斗或叉式抓斗等。

Apply to different kinds of material handling working conditions. According to the working environment, the grabbing attachments can be Orange Peel Grapple, Clamshell Bucket or other hydraulic grapples.

技术参数 Parameter

机重 Models	24T	36T	45T
动臂长度 (mm) Boom length	7000	8300	9500
斗杆长度 (mm) Arm length	5000	5800	6800
最大作业半径 (mm) Max working radius	11500	13600	15600
配置橙皮状抓斗(抓钳器)参考配套机重 Attached with orange peel grapple (OPG) counter weight	1000-1300Kg	1000-1300Kg	1000-1300Kg
配置贝壳式抓斗(贝壳斗)参考配套机重 Attached with clamshell bucket (CSB) counter weight	1000-1300Kg	1000-1300Kg	1000-1300Kg

压实轮 Compaction Wheel

性能特征 Characteristics

- 内置黄油润滑密封系统，维修保养方便。
- 结构简单，安装快捷，操作安全可靠。
- Grease sealing system built-in, convenient for maintenance.
- Upgraded design, quick installation, safe and reliable operation.

适用范围 Application

专为狭窄空间作业而设计，主要适用于路面、地基、坝基边坡等粘土、碎石、沥青混凝土的压实。

Working efficiently in narrow working environment, Apply to the compaction work of clay, gravel and asphalt concrete of pavements, dam foundations and slopes...etc.



贝型斗 Clamshell Bucket

适用范围 Application

适用于沟槽、沟渠等受限空间地基的挖掘及泥、沙、煤、碎石的装载，也用于船舶、火车、汽车装卸上述物料。

Apply to groove, such as the foundation ditch limited space mining and mud, sand, coal, gravel loaded, and can also be used to ship, train, automobile loading and unloading the above material.



性能特征 Characteristics

按客户需要有液压回转和不带液压回转两种，不带液压回转的贝型斗采用挖掘机铲斗油缸的油路，不用另外添加液压阀块及管路；带液压回转的贝型斗需添加一套液压阀块及管路来控制，同时油缸配置有活塞保护装置。

Clamshell bucket covers rotary type and non-rotary type. Non-rotary type uses excavator bucket cylinder oil pathway no need to add hydraulic valve and pipeline; rotary type needs to add one set of hydraulic valve and pipeline to control. Cylinders are with piston protective device.



技术参数 Parameter

配套机重 Machine Tonnage	名称 Description	参考重量(Kg) Weight	材料 Material
3-5T	不回转贝型斗 Non-rotary clamshell bucket	380	HARDOX+Q345B
	回转式贝型斗 Rotary clamshell bucket	420	
6-10T	不回转贝型斗 Non-rotary clamshell bucket	570	HARDOX+Q345B
	回转式贝型斗 Rotary clamshell bucket	620	
11-16T	不回转贝型斗 Non-rotary clamshell bucket	820	HARDOX+Q345B
	回转式贝型斗 Rotary clamshell bucket	880	
17-20T	不回转贝型斗 Non-rotary clamshell bucket	1080	HARDOX+Q345B
	回转式贝型斗 Rotary clamshell bucket	1180	
21-24T	不回转贝型斗 Non-rotary clamshell bucket	1200	HARDOX+Q345B
	回转式贝型斗 Rotary clamshell bucket	1300	
25-30T	不回转贝型斗 Non-rotary clamshell bucket	1320	HARDOX+Q345B
	回转式贝型斗 Rotary clamshell bucket	1450	
31-35T	不回转贝型斗 Non-rotary clamshell bucket	1450	HARDOX+Q345B
	回转式贝型斗 Rotary clamshell bucket	1600	
36-40T	不回转贝型斗 Non-rotary clamshell bucket	1680	HARDOX+Q345B
	回转式贝型斗 Rotary clamshell bucket	1850	
41-45T	不回转贝型斗 Non-rotary clamshell bucket	1950	HARDOX+Q345B
	回转式贝型斗 Rotary clamshell bucket	2150	

挖斗 Bucket

性能特征 Characteristics

公司可设计、生产各类品牌挖掘机挖斗。根据不同的施工环境和客户要求，科学解决应力问题，精心选择优质材料，并通过先进的电脑辅助设计，完善的制程焊接质量控制，保证了产品的结构强度、使用性能和产品质量。挖斗规格从0.1m³到12m³不等。

We can design and manufacture various bucket for any brands, ever can scientifically solve the problem of the stress according to the different working environment or requirements from customers, choose the selected material, and finish the design by CAD, also obtain the integrated quality controlling procedure for welding, so that the hardness of the structure, using capability and quality can be ensured. The specifier covers from 0.1m³ to 12m³ and so on.



技术参数 Parameter

1. 挖斗种类、性能及适用环境 (Category, capability and appropriate working environment)

类型 Type	项目 Item	材料 Material	配置与性能 Configuration and Capability	适用环境 Appropriate working environment
岩石型挖斗 Rock bucket		Hardox+NM360+Q345B	齿板及侧刃板选用国产耐磨板，国产优质斗齿座，因而具有耐磨、抗弯能力。 Adaptor plate and side plate are made of homemade material Nm360, domestic material high quality tooth plate, so that it can resist grinding and bending.	挖掘碎石、砾石、土中混有较硬石块时、次坚石、风化石的装载等重载作业场合。 For digging the rubble, gravel and clay with tough stone, or loading the secondary tough stone and rock.
		Hardox+Q345B	增加钢板，增加侧护板，安装防护板；斗齿座选用岩石型专用产品。因而具有很强耐磨，抗弯能力。 Consolidated plate on the bottom, enhance the thickness of side plate, and install protective board, the tooth plate is made specialized for rock, so that it can resist grinding and bending efficiently.	坚石、爆破后的矿石的装载等重载作业场合。 For loading the tough rock and the mineral from the explosion.



2. 三种挖斗材料的化学成分及机械性能比较 (Chemical Composition and Machinery Capability)

类型 Type	项目 Item	材料代号 Code	主要化学成分 Main chemical composition					布氏硬度 (HB)	伸长率 δ (%)	拉伸强度 (N/mm²) Drag and Extension intensity	屈服强度 (N/mm²) Bend intensity
			C	Si	Mn	P	S				
	锰板 Mn Board	Q345B	0.18	0.55	1.4	0.03	0.03	163-187	21	470-660	345
	国产耐磨板 Homemade Regrinding Board	NM360	0.20	0.3	1.3	0.02	0.006	360	16	1200	1020
	高强度耐磨板 High Intensity Regrinding Board	HARDOX-500	0.20	0.7	1.7	0.025	0.01	470-500	8	1550	1300

倾斜斗 Tilting Bucket

性能特征 Characteristics

使用高强度的材料，适用于4-30吨位的各种机型，可倾斜角度为0-45°，作业方便、快捷。

倾斜斗能改变挖掘机（铲）挖斗的倾斜角度，不需改变挖掘机位置就能进行作业，减少机械磨损和油耗，提高工作效率。

Use material of high hardness; Suitable for different machines of 4-30ton. Tilt angle can be 0-45°. Convenient and quick for operation.

Tilting bucket, it can change the angle of the bucket without changing the position of the excavator to operate, thus reduce the wear loss and oil cost and improve the work efficiency.



技术参数 Parameter

型号 Model	总重量(Kg) Gross weight	工作压力(bar) Working pressure	液压油动范围(L/min) Hydraulic flux	斗容SEA(m³) Bucket capacity
EX60	450	30~120	10~20	0.4
EX120	750	30~210	10~21	0.6
EX200	950	30~210	10~22	0.8
EX300	1200	30~210	10~23	1.4

装载斗 Loader Bucket

性能特征 Characteristics

专业生产各类品牌装载机装载斗，斗容规格从0.8m³到8m³不等，主刀刀板上可配斗齿，也可配带螺旋纹的孔的活动刀板。

根据不同的工况，主要分为轻型斗、岩石斗、侧向装载斗几种。

Specialized in producing loader buckets for various brands, bucket capacity range from 0.8m³ to 8m³, bolt-on cutting edge and teeth optional. According to different work conditions, we offer light material loader buckets, rock loader buckets, side dump loader buckets and high lipping loading buckets to customers.

适用范围 Application

- ◆ 轻型斗主要适用于挖掘粘土、砂石、玻璃、肥料和垃圾处理、食品加工等轻载作业。
- ◆ 岩石斗主要适用于挖掘硬土、砾石以及坚硬山石等重载作业。
- ◆ 侧向装载斗主要适用于开拓坚硬的矿洞、隧道等作业。

- ◆ The light material loader bucket is mainly used in light work, such as digging clay, sand, glass, fertilizer, garbage and so on.
- ◆ The rock loader bucket is mainly used in harsh work, such as digging hard soil, gravel, hard rock and so on.
- ◆ Side dump bucket is mainly used in narrow environment or limited space for efficiently loading light materials or heavy materials.

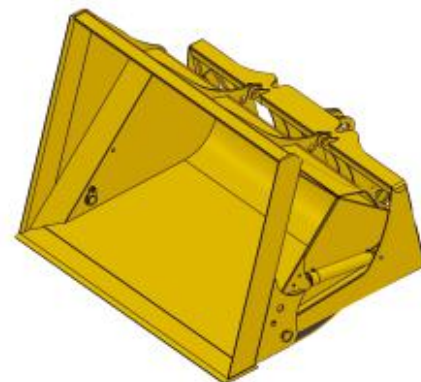

松土器 Ripper

适用范围 Application

用于硬土、碎石、次坚石、风化石的粉碎，方便挖斗挖掘及装料。
For smashing the hard soil, gravel, secondly tough stone and rock. Convenient for buckets digging and loading.

性能特征 Characteristics

一般是单齿，也有二齿或三齿，挖掘切入能力强。
Generally it's with 1 tine, but 2 or 3 tines are also available. Excellent digging cut-in ability.



技术参数 Parameter

配套机重 Machine Tonnage	名称 Description	主板厚度(mm) Main plate thickness	参考重量(Kg) Weight	材料 Material
3-5T	松土器 Ripper	δ = 50	260	Q345B
6-10T	松土器 Ripper	δ = 60	380	Q345B
11-16T	松土器 Ripper	δ = 80	540	Q345B
17-20T	松土器 Ripper	δ = 100	680	Q345B
21-24T	松土器 Ripper	δ = 100	720	Q345B
25-30T	松土器 Ripper	δ = 100	780	Q345B
31-35T	松土器 Ripper	δ = 100	820	Q345B
36-40T	松土器 Ripper	δ = 100	870	Q345B
41-45T	松土器 Ripper	δ = 100	920	Q345B

快换接头 Quick Hitch



性能特征 Characteristics

根据客户要求公司可为各种品牌挖掘机设计、生产快换接头，快换接头能在挖掘机上迅速安装各种配置附件（挖斗、破碎锤、液压剪等），能扩大挖掘机使用范围，并能节省时间，提高工效。

快换接头特性：

1. 使用高强度的材料，适用于4-45吨位的各种机型。
2. 使用液压单向阀的安装装置，保证安全。
3. 挖掘机配置件无需改装，也不用拆卸销轴就能更换，因此安装迅速，能极大提高工作效率。

We can design and produce quick hitches for various brands of excavators according to customers' requirement. Quick hitch can be used on the excavators to change every accessory (such as bucket, breaker, shear, etc) easily and quickly, which has enlarged the use scope of the excavators and a lot of time.

1. Use material of high hardness, suitable for different machines of 4-45ton.
2. Use security device of hydraulic control valve to ensure the safety.
3. Can change the accessories without disassembling the pin and axle. Thus realize faster installation and much higher efficiency.



技术参数 Parameter

配套机重 Machine Tonnage	总重量 (Kg) Gross Weight	工作压力 (Bar) Working Pressure	液压油流量 (L/min) Hydraulic Flux	搬运总重量 (Ton) Loading Weight
6T	75	30~210	10~20	4~7
12T	150	30~210	10~20	8~13
20T	280	30~210	10~20	20~20
30T	400	30~210	10~20	28~32
40T	500	30~210	10~20	35~45

叉式抓爪 Grapple

适用范围 Application

适用于废旧金属、石块、木料装卸及搬运。
 For waste metals disposal, stones, woods loading, unloading and moving.



性能特征 Characteristics

根据不同需求，有机械式和液压式两种，液压式又分带液压回转和不带液压回转两种。机械式叉式抓爪采用挖掘机铲斗油缸推动，不需另外添加液压阀块及管路；不带回转的液压式叉式抓爪要添加一套液压阀块及管路来控制，带回转的液压式叉式抓爪需添加两套液压阀块及管路来控制。

According to the different demand, there are mechanical grapple and hydraulic grapple. Hydraulic grapples have rotary and non-rotary two type. Mechanical grapples driven by excavator bucket cylinder, no need to add hydraulic valve and pipeline. Rotary hydraulic grapple needs to add one set of hydraulic valve and pipeline to control, while rotary hydraulic grapple needs to add two sets.



技术参数 Parameter

配套机重 Machine Tonnage	名称 Description	最大开口(mm) Max. opening width	材料 Material
3-5T	单板式抓爪 Single plate grapple	1250	HARDOX+Q345B
	箱体式抓爪 Box type grapple		
6-10T	单板式抓爪 Single plate grapple	1450	HARDOX+Q345B
	箱体式抓爪 Box type grapple		
11-16T	单板式抓爪 Single plate grapple	1700	HARDOX+Q345B
	箱体式抓爪 Box type grapple		
17-20T	单板式抓爪 Single plate grapple	1900	HARDOX+Q345B
	箱体式抓爪 Box type grapple		
21-24T	单板式抓爪 Single plate grapple	2050	HARDOX+Q345B
	箱体式抓爪 Box type grapple		
25-30T	单板式抓爪 Single plate grapple	2200	HARDOX+Q345B
	箱体式抓爪 Box type grapple		
31-35T	单板式抓爪 Single plate grapple	2300	HARDOX+Q345B
	箱体式抓爪 Box type grapple		
36-40T	单板式抓爪 Single plate grapple	2400	HARDOX+Q345B
	箱体式抓爪 Box type grapple		
41-45T	单板式抓爪 Single plate grapple	2500	HARDOX+Q345B
	箱体式抓爪 Box type grapple		
65T	单板式抓爪 Single plate grapple	2900	HARDOX+Q345B
	箱体式抓爪 Box type grapple		

液压抓钳器 Hydraulic Orange Peel Grab

适用范围 Application

- 适用于抓取碎石、废旧金属、工业废料、建筑垃圾、生活垃圾。
- 车厢内抓取作业。
- For grabbing gravels, waste metals, industry waste, construction garbage, household waste.
- Grab operation under other conditions.



性能特征 Characteristics

根据需求不同，有液压回转和不带液压回转两种。不带液压回转的抓钳器采用挖掘机铲斗油缸的油路，不需另外添加液压阀块及管路；带回转的抓钳器要添加一套液压阀块及管路来控制。同时油缸配置有活塞保护装置。

According to the different demand, there are hydraulic rotary peel grab and non-rotary type two kinds. Non-rotary type uses excavator bucket cylinder oil pathway, no need to add hydraulic valve and pipeline; hydraulic swing type need to add one set of hydraulic valve and pipeline to control cylinders are with piston protective device.

技术参数 Parameter

配套机重 Machine Tonnage	名称 Description	抓爪数量 Number of tines	材料 Material
3-5T	不回转型式液压抓钳器 Non-rotary hydraulic orange peel grab	4	Q345B+NM400
	回转型式液压抓钳器 Rotary hydraulic orange peel grab		
6-10T	不回转型式液压抓钳器 Non-rotary hydraulic orange peel grab	4	Q345B+NM400
	回转型式液压抓钳器 Rotary hydraulic orange peel grab		
11-16T	不回转型式液压抓钳器 Non-rotary hydraulic orange peel grab	5	Q345B+NM400
	回转型式液压抓钳器 Rotary hydraulic orange peel grab		
17-20T	不回转型式液压抓钳器 Non-rotary hydraulic orange peel grab	5	Q345B+NM400
	回转型式液压抓钳器 Rotary hydraulic orange peel grab		
21-24T	不回转型式液压抓钳器 Non-rotary hydraulic orange peel grab	5	Q345B+NM400
	回转型式液压抓钳器 Rotary hydraulic orange peel grab		
25-30T	不回转型式液压抓钳器 Non-rotary hydraulic orange peel grab	6	Q345B+NM400
	回转型式液压抓钳器 Rotary hydraulic orange peel grab		
31-35T	不回转型式液压抓钳器 Non-rotary hydraulic orange peel grab	6	Q345B+NM400
	回转型式液压抓钳器 Rotary hydraulic orange peel grab		
36-40T	不回转型式液压抓钳器 Non-rotary hydraulic orange peel grab	6	Q345B+NM400
	回转型式液压抓钳器 Rotary hydraulic orange peel grab		
41-45T	不回转型式液压抓钳器 Non-rotary hydraulic orange peel grab	6	Q345B+NM400
	回转型式液压抓钳器 Rotary hydraulic orange peel grab		

液压回转筛型斗 Hydraulic Swing Demolition Sorting Grab

性能特征 Characteristics

带液压回转筛斗需添加两套液压阀块及管路来控制。油缸采用液控单向阀保持抓取可靠，不松散。

Hydraulic swing demolition & sorting grab needs to be equipped with 2 sets of hydraulic valve and pipeline. Cylinders adopt the hydraulic one-way control valve to keep the grab stable and tight.

适用范围 Application

抓取建筑垃圾、工业废料、工业废料、较大的硬土及石块。

For grasping the construction remains, industry material and waste, the massive tough mud and stone.



技术参数 Parameter

配套机重 Machine Tonnage	名称 Description	最大开口(mm) Max. opening width	参考重量 (Kg) Weight	材料 Material
6-10T	筛型斗 Demolition & sorting grab	640	540	HARDDX+Q345B
11-16T	筛型斗 Demolition & sorting grab	800	840	HARDDX+Q345B
17-20T	筛型斗 Demolition & sorting grab	1000	1000	HARDDX+Q345B
21-24T	筛型斗 Demolition & sorting grab	1150	1300	HARDDX+Q345B
25-30T	筛型斗 Demolition & sorting grab	1200	1500	HARDDX+Q345B
31-35T	筛型斗 Demolition & sorting grab	1250	1700	HARDDX+Q345B
36-40T	筛型斗 Demolition & sorting grab	1300	2000	HARDDX+Q345B
41-45T	筛型斗 Demolition & sorting grab	1400	2200	HARDDX+Q345B